



St Mary the Virgin Church of England Primary School

Hartfield East Sussex TN7 4AA

Executive Headteacher: Mr James Procter

Head of School: Miss Becca Hare

Email: office@st-maryhartfield.e-sussex.sch.uk

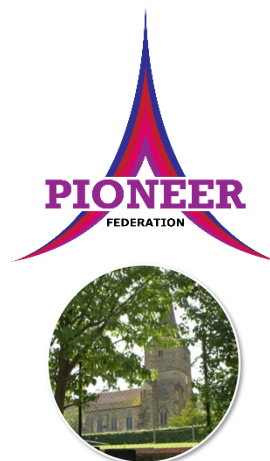

Term 2 Week 2

Friday 13th November

National Anti-Bullying Week

Next week, each class will be taking part in various activities to participate in National Anti-Bullying Week.

Monday 16th November is Odd Socks Day to highlight that being different is brilliant, so we encourage you and your child(ren) to wear odd socks.



Make sure you ask your child(ren) what they get up to across the week!

Attendance

Whole school: week: **98.2%**
year: **96.1%**

Maple: **96.3%** Cherry: **99.3%**
Willow: **98%** Lilac: **98.3%**

Less than 94.9% - Red 95 to 96.4% - Amber
96.5 to 99.9% - Green 100% - Gold



Head Teacher's Awards

Noah H: for incredible progress in handwriting, spelling and stamina to write longer pieces!

Thomas W: for unbelievable progress in writing: not only a huge improvement in handwriting but in the amount, too!

Well done, Noah and Thomas!



Top Tips

- Monday 16th November:** 'odd sock day'.
- Monday 16th November:** Lilac to be collected from Briars.
- Wednesday 18th November:** Lilac and Willow dropped and collected Ashdown Forest Centre.
- Letters home:** Cherry and Lilac Class, tree planting at Briars; Willow and Lilac Class, trip to Ashdown Forest Centre, whole school, parent consultation evenings and sign up.



Learning Powers Certificate

In our Celebration Assembly today, the following children celebrated their achievements:

Maple: Elsie
Cherry: Evalyn
Willow: Iris
Lilac: Hugo

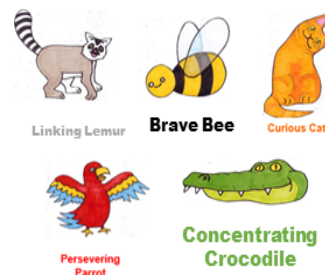

Well done to all!

If you need the newsletter, or any other school letter, to be in a different format, please speak with Mrs Funnell in the school office.

If you need help or support with access to any information, please also contact Mrs Funnell.

Sports Award

Mr D's Sports Stars of the week have been chosen as they were all winners in the Inter-House cross country.

Well done to: **Ashleigh** **Brax** **Tiago** **Reece**



Reading Reward Scheme

Thank you for your ongoing support in totting up the minutes read at home, and the additional comments you make.

Reading Records are checked weekly in school by the class teacher or teaching assistant and minutes are counted for the class total.

This week's results for our Reward Scheme:

Maple: 404 minutes **Cherry:** 180 minutes

Willow: 2,008 minutes **Lilac:** 1,876 minutes

Well done, Willow!



Mr D's After School FOOTBALL Club

As this is new we wanted to update you about our new Football Club. If you are interested in joining and would like more information on the Risk Assessment, this is being posted on the website for you to view.

Government guidance on Sport and Physical Education recognises the importance that children continue to remain fit and active and, wherever possible, have the 60 active minutes of daily physical activity recommended by the Chief Medical Officers.

What better way to do this than through Football!



Mr D has set up this brand new club for girls and boys from Years 1-6 on a Monday from 3.15pm until 4.30pm. The club will enable the children to enjoy the physical aspects of Football whilst developing a wide range of skills. Games and drills are being designed to be delivered in a fun and COVID-safe manner in the secure environment of School.

Each child will have access to their own equipment and will enjoy developing their skills and play games within their own Bubbles.

Spaces are limited, so please contact the School Office for more information and a form.

Dates for your diary

November

16th: 'Odd Sock' Day for Anti-Bullying Week
16th: Lilac to Briars
18th: Lilac and Willow Ashdown Forest Centre
19th: Willow Forest School
24th: Parent Consultation 3:45pm - 6:00pm
26th: Parent Consultation 3:45pm - 6:00pm

December

3rd: Lilac Forest School
9th: Flu Vaccinations
11th: PTFA 'Mufti' Day: £1 to wear
your own clothes
16th: FGB Meeting
18th: Last Day Term 2

January

4th: Inset Day
5th: First Day Term 3

Lilac Class – Victorian Day!



We had such a fun and interesting day on Thursday, holding our very own version of the Great Exhibition in Lilac Class. The children looked brilliant in their Victorian outfits; we even had a couple of Sherlock Holmes' thrown into the mix. At home, it's clear the children have been working so incredibly hard to make their very own models of inventions that were created in the Victorian era. We had everything, from working lightbulbs to zoetropes, wireless energy to Christmas crackers! The children loved hearing about and looking at others' models. As well as this, we had a go at making jam tarts using a traditional Victorian recipe and wrote a newspaper report all about a day. After a jam-packed day – pardon the pun – we finished off the day eating our baked goods and explored Wonderland with Alice. What a fantastic day had by all!

Remembrance Day



On Wednesday 11th November, the whole school paused to visit the church grave yard and place crosses at a war memorial grave. The children, along with Rev Julie, went with their teachers to have a two-minute silence to remember those who fought for peace and for the long-lasting peace we are fortunate enough to have in our country. Mr Gray also put a wreath on the memorial in the village with a message which some Year 6s wrote, in memory of the bravery and courage of the soldiers.



Cherry Class - Forest School

Thursday 12th November 2020

The **Impact** of Forest School for the children is the knowledge the children have gained from the Forest School experience. It can be seen through the skills, art and craft activities, observations and knowledge of the fruit, plants and trees in relation to the seasons as well as the skills involved in learning how to play Forest School games.



This week, each child had made a bird and found a suitable stick along their journey to use to make it fly.

They listened to birdsong and looked out for birds and nests in trees along the 'Forest Way' taking advantage of the '**Cultural Capital**' of their local environment.

When making their birds, they each identified one from a sheet of British birds before colouring the feathers and cutting them out.



Before we left school, we looked at a map of Europe and the world to talk about where the birds might fly to when they migrate.

The children identified holly berries, rose hips and sloe berries for their birds to feed on, along with flies and spiders they had spotted in the meadows.



Once we were in the woods, the children were great at **tapping sticks** in time and following **rhythm and movement patterns**.

They played a game, listening out for different bird calls and using their bird identification sheets to learn the names of the birds they had made.

The children followed their own ideas and imaginations. There was lots of exploring and finding leaves and sticks. Some children created lovely nests for their birds to rest in after their long flight.

The birds even queued for the hammock, where they played games and sang songs as they took turns with swinging, relaxing and pushing and there was time to explore and climb and fly their birds in and around the woodland.



The recent rain has made the woodland stream flow, so the children set about creating bridges of sticks across the water. At the end of the afternoon the children were silent for a **woodland whisper**, which started as 'robin' and ended up completely as 'robin'! Excellent teamwork and listening skills, Cherry Class!

The children discussed and reflected on what they had enjoyed about Forest School on their walk up the hill.

"I loved swinging"

"I liked making my bird and making a nest with colourful leaves"

"I liked going on the balancing rope"



Thanks to the brilliant volunteers who make going to Forest School possible as the children are lucky to have access to the woods to develop their independence, resilience and well-being. The Forest School association are calling for all children nationally to have access to nature like we do. *"We are calling for a **Nature Premium** to fund regular nature experiences for every child."* Take a look here why: [#naturepremium](https://www.naturepremium.org/)

Cherry Class Planted Trees

Friday 13th November 2020

This week, Cherry Class had the opportunity to visit The Briars Lodge Field Centre to plant some trees in their grounds.

It was a fantastic opportunity for the children to observe and hold tree saplings before planting.



Mrs Rowberry talked to us about the trees that we were going to plant.



The children worked together to help support the trees whilst the soil was pushed around the roots.

"I love planting the trees. It was fun stamping the mud down!"

"I can't wait to see them when they have grown."



The children used trowels carefully to move the soil around the trees and cover up the roots.

We had to make sure the soil was well compressed.



The **impact** of this trip supports children's engagement with nature, encouraging a respect and love of nature; and **understanding** the positivity of trees.

This helps children to take notice of the nature around us and gain an invested interest that will support how they take care of the world around us.

A message from your PTFA

St Mary's



During these unprecedented times and not being able to have things like the Christmas Fayre, we need to adapt and think of ways to continue to raise money for our school and as during the last lockdown I am sure many of us relied on ordering things online, we have decided to set up an **Amazon Smile Account**.

The Amazon Smile Account works by donating a small percentage of the costs of an order to your chosen charity. Goods are ordered in exactly the same way but once you have set up a link, for every order you place there is a donation to the charity of choice, which basically means the school will benefit from anything you spend! To achieve this, participants initially need to set up an Amazon Smile connection nominating St Mary's School Hartfield PTFA as their chosen recipient. This needs to be done on **ALL** devices you use and Amazon have provided a link that should take you straight to the page <https://smile.amazon.co.uk/ch/1048046-0>

I am aware that on different devices it might differ slightly so if you have trouble finding it on your settings type Amazon Smile into the search bar and it should bring up a banner saying *enable amazon smile*. It does say you need to have the newest update of amazon so additional encouragement to get your account up to date!

Once you have signed up, it should say that your notifications are enabled to ON and that St Mary's is your selected charity.

We would like to ask as many of you as possible to get involved, as well as encouraging your family, friends and anybody else who is happy to support our school to sign up.

If anyone is having trouble, please let us know and we will be happy to assist.

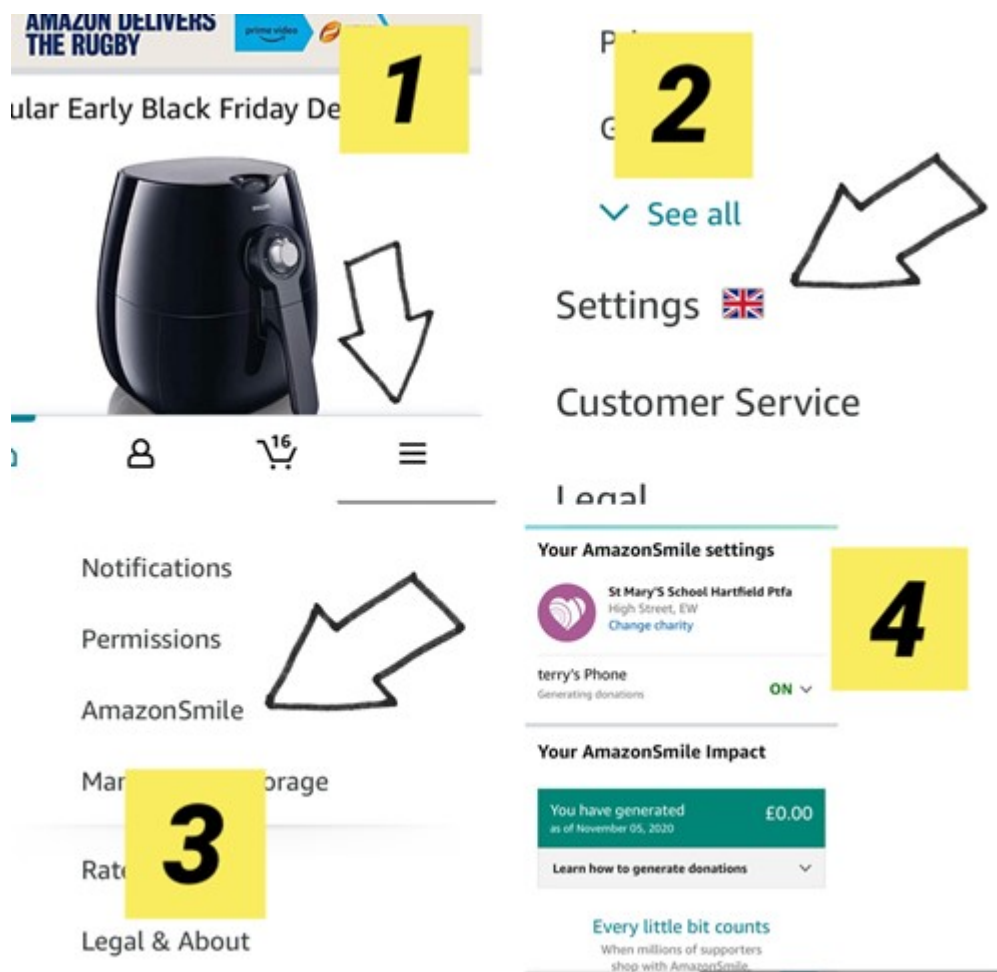

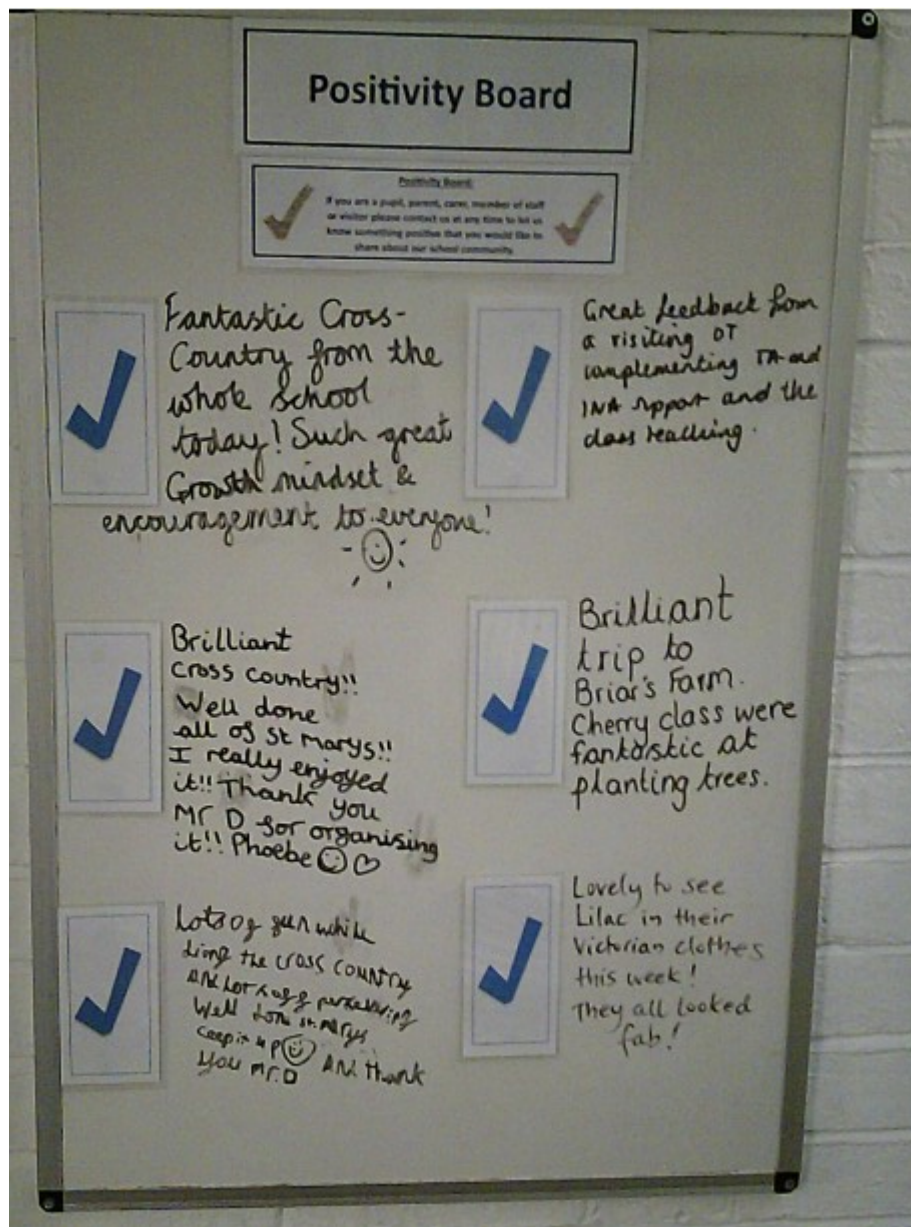

Positivity Board

This board enables us to write positive comments, or thoughts, from parents, carers, staff, children and visitors that they would like to share with others about the school, their classes, the children or events.

Please contact us at any time to let us know something that you would like to share. In the newsletter every week, there will be a picture to share and celebrate the positivity within our school.



School Ties

Our order for school ties has arrived and are now available to purchase from the school



office at £4 each.



Technology

We have been working hard to put together online learning for times when you may need to be isolating at home or if we enter another period of full lockdown. As this is all 'online,' please contact the school on 01892 770221, if you need help to access technology (i.e. laptops or broadband) to support this within your home.



Well Being Poster

As we continue in the new period of 'staying at home', this week's poster suggests 10 ways we can become 'mentally tough'!



Opportunity

East Sussex
**Parent
Carer
Forum**



**GUEST
SPEAKER**

Dr Emily Lovegrove

Psychologist, lecturer, and author of 'Autism, Bullying and Me' will be joining us to talk about her work on autism and anti-bullying strategies, followed by a Q&A.

11am—12.30pm
Thursday 26th November
Via Zoom

To attend this FREE event, email info@espcf.org.uk



Benny

This week, Benny has been keeping us well exercised out of school and did not mind at all that some of us were wearing our pyjamas!



Watching (not chasing) the sheep!

Another fabulous game of Pooh Sticks!



St Mary the Virgin Church of England Primary School, Hartfield, East Sussex, TN7 4AA

Tel: 01892 770221 Email: office@st-maryhartfield.e-sussex.sch.uk Website: www.pioneerfederation.co.uk